



# DURARO

## Stainless Steel Castors

**Application:**  
Kitchen trolleys; food carts; food processing plants;  
restaurants and commercial kitchens;  
laboratory equipments.

**Size Available:**  
75x32, 100x32, 125x32, 150x32, 200x32mm

If your mobile equipment is subjected to frequent contact or exposure to moisture, our Duraro would be your absolute choice of castor.

For the same reason, it is a must for most kitchen and food carts which are constantly moved in and out of refrigerating room and steamy kitchen, then hose cleaned to rid of food debris and oil stain, nothing other than stainless steel can stay shiny under such adverse conditions.

On the other extreme, medical or laboratory equipments that has to be sanitized with disinfectants would find Duraro suitable at all time.

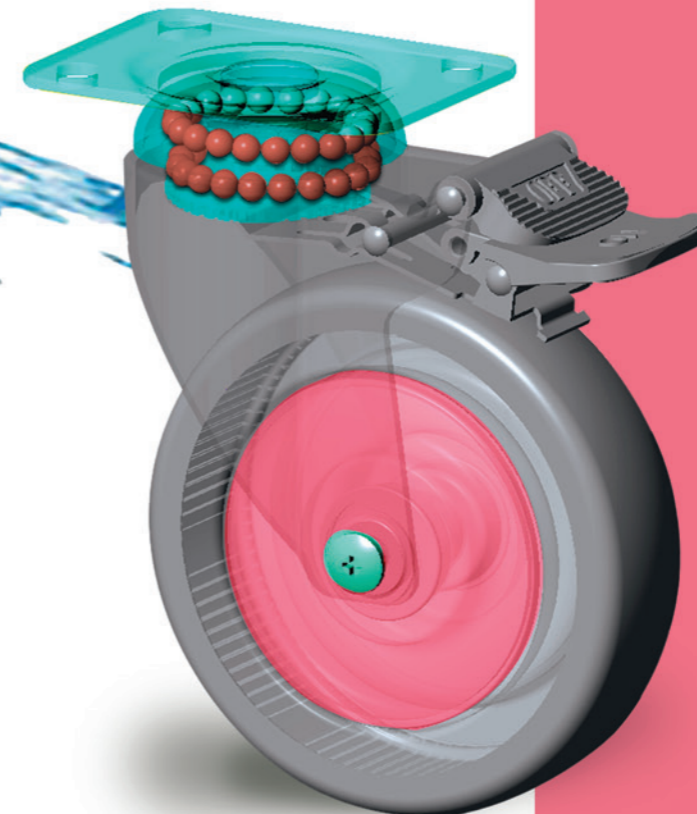



# DURARO

## Stainless Steel Castors

Pressed stainless steel double ballrace swivel yoke, electrolytic polishing finish



### TB/A Total locking brake

Total Lock system locks both swivel head and wheel simultaneously for secure parking. Integrated ON/OFF Nylon brake pedals for easy and quiet operation.



### DB/A Directional locking brake

Directional Lock permits free wheel rotation while swivel head remains locked, an easy way to keep equipment traveling straight. Integrated ON/OFF Nylon brake pedals for easy and quiet operation. Release pedal in green color.

## P Top Plate Fitting



### PRB-SS Wheel

Plastic hub, grey color elastic rubber tire

Brake type	mm	mm		mm	mm	mm	mm	mm	kg	Code
<b>TB/A</b> Total locking brake	75	32		95 x 70	75 x 52 / 72 x 45	9.0	33.0	107.0	50	Y380XP1SS/W324S
	75	32		77 x 67	61.5 x 52 / 56 x 45	8.5	33.0	107.0	50	Y380XP2SS/W324S
<b>TB/B</b> Total locking brake	100	32		95 x 70	75 x 52 / 72 x 45	9.0	40.5	135.0	80	Y480XP1SS/W424DS
	100	32		77 x 67	61.5 x 52 / 56 x 45	8.5	40.5	135.0	80	Y480XP2SS/W424DS
	125	32		95 x 70	75 x 52 / 72 x 45	9.0	39.0	161.0	100	Y580XP1SS/W524DS
	125	32		77 x 67	61.5 x 52 / 56 x 45	8.5	39.0	161.0	100	Y580XP2SS/W524DS
	150	32		95 x 70	75 x 52 / 72 x 45	9.0	50.0	189.5	100	Y680XP1SS/W624DS
	150	32		77 x 67	61.5 x 52 / 56 x 45	8.5	50.0	189.5	100	Y680XP2SS/W624DS
	75	32		95 x 70	75 x 52 / 72 x 45	9.0	41.0	107.0	50	Y380P1SS/W324S
	75	32		77 x 67	61.5 x 52 / 56 x 45	8.5	41.0	107.0	50	Y380P2SS/W324S
	100	32		95 x 70	75 x 52 / 72 x 45	9.0	40.5	135.0	80	Y480P1SS/W424DS
	100	32		77 x 67	61.5 x 52 / 56 x 45	8.5	40.5	135.0	80	Y480P2SS/W424DS
125	32		95 x 70	75 x 52 / 72 x 45	9.0	39.0	161.0	100	Y580P1SS/W524DS	
125	32		77 x 67	61.5 x 52 / 56 x 45	8.5	39.0	161.0	100	Y580P2SS/W524DS	
150	32		95 x 70	75 x 52 / 72 x 45	9.0	46.5	189.5	100	Y680P1SS/W624DS	
150	32		77 x 67	61.5 x 52 / 56 x 45	8.5	46.5	189.5	100	Y680P2SS/W624DS	

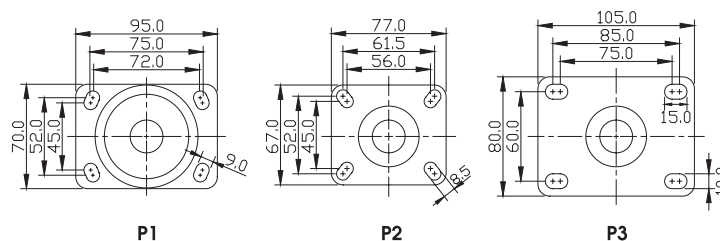











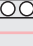

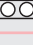

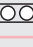



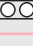



**TB/BS** Total locking brake  
 Total Lock system simultaneously locks both swivel head and wheel for a secure parking.  
 Zinc-alloy brake pedal.

## P Top Plate Fitting

### PRB-SS Wheel Plastic hub, grey color elastic rubber tire

Brake type	mm	mm		mm	mm	mm	mm	mm	kg	Code
<b>DB/4</b> Dir. locking brake	75	32		95 x 70	75 x 52 / 72 x 45	9.0	33.0	107.0	50	Y380XDP1SS/W324S
	75	32		77 x 67	61.5 x 52 / 56 x 45	8.5	33.0	107.0	50	Y380XDP2SS/W324S
	100	32		95 x 70	75 x 52 / 72 x 45	9.0	40.5	135.0	80	Y480XDP1SS/W424DS
	100	32		77 x 67	61.5 x 52 / 56 x 45	8.5	40.5	135.0	80	Y480XDP2SS/W424DS
	125	32		95 x 70	75 x 52 / 72 x 45	9.0	39.0	161.0	100	Y580XDP1SS/W524DS
	125	32		77 x 67	61.5 x 52 / 56 x 45	8.5	39.0	161.0	100	Y580XDP2SS/W524DS
	150	32		95 x 70	75 x 52 / 72 x 45	9.0	50.0	189.5	100	Y680XDP1SS/W624DS
	150	32		77 x 67	61.5 x 52 / 56 x 45	8.5	50.0	189.5	100	Y680XDP2SS/W624DS
Non-brake Free swivel	75	32		95 x 70	75 x 52 / 72 x 45	9.0	33.0	107.0	50	Y381P1SS/W324S
	75	32		77 x 67	61.5 x 52 / 56 x 45	8.5	33.0	107.0	50	Y381P2SS/W324S
	75	32		105 x 80	85 x 60 / 75 x 60	10.0	33.0	107.0	50	Y381P3SS/W324S
	100	32		95 x 70	75 x 52 / 72 x 45	9.0	40.5	135.0	80	Y481P1SS/W424DS
	100	32		77 x 67	61.5 x 52 / 56 x 45	8.5	40.5	135.0	80	Y481P2SS/W424DS
	100	32		105 x 80	85 x 60 / 75 x 60	10.0	40.5	135.0	80	Y481P3SS/W424DS
	125	32		95 x 70	75 x 52 / 72 x 45	9.0	39.0	161.0	100	Y581P1SS/W524DS
	125	32		77 x 67	61.5 x 52 / 56 x 45	8.5	39.0	161.0	100	Y581P2SS/W524DS
	125	32		105 x 80	85 x 60 / 75 x 60	10.0	39.0	161.0	100	Y581P3SS/W524DS
	150	32		95 x 70	75 x 52 / 72 x 45	9.0	50.0	189.5	100	Y681P1SS/W624DS
	150	32		77 x 67	61.5 x 52 / 56 x 45	8.5	50.0	189.5	100	Y681P2SS/W624DS
	150	32		105 x 80	85 x 60 / 75 x 60	10.0	50.0	189.5	100	Y681P3SS/W624DS



 Stainless steel

# DURARO

## Stainless Steel Castors

Pressed stainless steel double ballrace swivel yoke, electrolytic polishing finish



**TB** Total locking brake  
Total Lock system locks both swivel head and wheel simultaneously for secure parking. Integrated ON/OFF Nylon brake pedals for easy and quiet operation.



**DB** Directional locking brake  
Directional Lock permits free wheel rotation while swivel head remains locked, an easy way to keep equipment traveling straight. Integrated ON/OFF Nylon brake pedals for easy and quiet operation. Release pedal in green color.

### P Top Plate Fitting

#### PRB-SS Wheel Plastic hub, grey color elastic rubber tire

Brake type									Code	
	mm	mm	mm	mm	mm	mm	mm	kg		
Non-brake Fixed	75	32		95 x 77	75 x 52 / 72 x 45	9.0	107.0	50	Y382P1SS/W324S	
	100	32		95 x 77	75 x 52 / 72 x 45	9.0	135.0	80	Y482P1SS/W424DS	
	125	32		95 x 77	75 x 52 / 72 x 45	9.0	161.0	100	Y582P1SS/W524DS	
	150	32		95 x 77	75 x 52 / 72 x 45	9.0	189.5	100	Y682P1SS/W624DS	
	75	32		67 x 77	52 x 61.5 / 45 x 56	8.5	107.0	50	Y385P2SS/W324S	
	100	32		67 x 77	52 x 61.5 / 45 x 56	8.5	135.0	80	Y485P2SS/W424DS	
	125	32		67 x 77	52 x 61.5 / 45 x 56	8.5	161.0	100	Y585P2SS/W524DS	

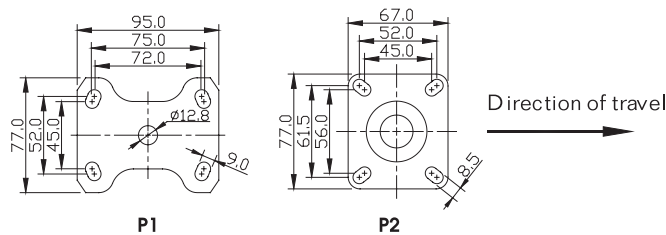



**TB** Total locking brake  
 Total Lock system simultaneously locks both swivel head and wheel for a secure parking.  
 Zinc-alloy brake pedal.

## P Top Plate Fitting



### TPR-SS Wheel Plastic hub, grey color thermoplastic rubber tire

Brake type	mm	mm		mm	mm	mm	mm	mm	kg	Code
<b>TB</b> Total locking brake	100	32		95 x 70	75 x 52 / 72 x 45	9.0	40.5	135.0	80	Y480XP1SS/W403DS
	100	32		77 x 67	61.5 x 52 / 56 x 45	8.5	40.5	135.0	80	Y480XP2SS/W403DS
	125	32		95 x 70	75 x 52 / 72 x 45	9.0	39.0	161.0	100	Y580XP1SS/W503DS
	125	32		77 x 67	61.5 x 52 / 56 x 45	8.5	39.0	161.0	100	Y580XP2SS/W503DS
	200	32		95 x 70	75 x 52 / 72 x 45	9.0	57.5	235.0	120	Y880XP1SS/W803UXS
<b>TB</b> Total locking brake	100	32		95 x 70	75 x 52 / 72 x 45	9.0	40.5	135.0	80	Y480P1SS/W403DS
	100	32		77 x 67	61.5 x 52 / 56 x 45	8.5	40.5	135.0	80	Y480P2SS/W403DS
	125	32		95 x 70	75 x 52 / 72 x 45	9.0	39.0	161.0	100	Y580P1SS/W503DS
	125	32		77 x 67	61.5 x 52 / 56 x 45	8.5	39.0	161.0	100	Y580P2SS/W503DS
<b>DB</b> Dir. locking brake	100	32		95 x 70	75 x 52 / 72 x 45	9.0	40.5	135.0	80	Y480XDP1SS/W403DS
	100	32		77 x 67	61.5 x 52 / 56 x 45	8.5	40.5	135.0	80	Y480XDP2SS/W403DS
	125	32		95 x 70	75 x 52 / 72 x 45	9.0	39.0	161.0	100	Y580XDP1SS/W503DS
	125	32		77 x 67	61.5 x 52 / 56 x 45	8.5	39.0	161.0	100	Y580XDP2SS/W503DS
	200	32		95 x 70	75 x 52 / 72 x 45	9.0	57.5	235.0	120	Y880XDP1SS/W803UXS



Stainless steel

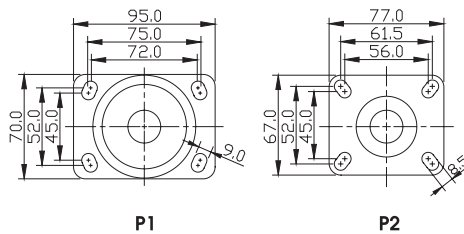

# DURARO

## Stainless Steel Castors

Pressed stainless steel double ballrace swivel yoke, electrolytic polishing finish



### TB Total locking brake

Total Lock system locks both swivel head and wheel simultaneously for secure parking. Integrated ON/OFF Nylon brake pedals for easy and quiet operation.



### DB Directional locking brake

Directional Lock permits free wheel rotation while swivel head remains locked, an easy way to keep equipment traveling straight. Integrated ON/OFF Nylon brake pedals for easy and quiet operation. Release pedal in green color.

## P Top Plate Fitting



### TPR-SS Wheel Plastic hub, grey color thermoplastic rubber tire

Brake type	mm	mm	mm	mm	mm	mm	mm	mm	kg	Code
Non-brake Free swivel	100	32		95 x 70	75 x 52 / 72 x 45	9.0	40.5	135.0	80	Y481P1SS/W403DS
	100	32		77 x 67	61.5 x 52 / 56 x 45	8.5	40.5	135.0	80	Y481P2SS/W403DS
	100	32		105 x 80	85 x 60 / 75 x 60	10.0	40.5	135.0	80	Y481P3SS/W403DS
	125	32		95 x 70	75 x 52 / 72 x 45	9.0	39.0	161.0	100	Y581P1SS/W503DS
	125	32		77 x 67	61.5 x 52 / 56 x 45	8.5	39.0	161.0	100	Y581P2SS/W503DS
	125	32		105 x 80	85 x 60 / 75 x 60	10.0	39.0	161.0	100	Y581P3SS/W503DS
	200	32		95 x 70	75 x 52 / 72 x 45	9.0	57.5	235.0	120	Y881P1SS/W803UXS



Brake type	mm	mm	mm	mm	mm	mm	mm	kg	Code
Non-brake Fixed	100	32		95 x 77	75 x 52 / 72 x 45	9.0	135.0	80	Y482P1SS/W403DS
	125	32		95 x 77	75 x 52 / 72 x 45	9.0	161.0	100	Y582P1SS/W503DS
	100	32		67 x 77	52 x 61.5 / 45 x 56	8.5	135.0	80	Y485P2SS/W403DS
	125	32		67 x 77	52 x 61.5 / 45 x 56	8.5	161.0	100	Y585P2SS/W503DS



### TPR-SS/AS Wheel Conductive wheels are also available

Plastic hub, grey color conductive thermoplastic rubber tire, stainless steel ball bearings, stainless steel threadguards

	Code
100 x 32mm	W403DS-AS
125 x 32mm	W503DS-AS



Electrical Resistance  $\leq 10^4 \Omega$

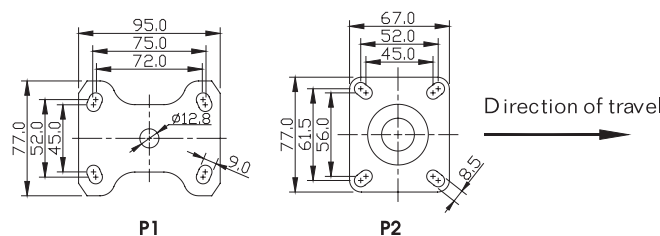



**TB/BS** Total locking brake  
 Total Lock system simultaneously locks both swivel head and wheel for a secure parking.  
 Zinc-alloy brake pedal.

## P Top Plate Fitting

### TPU-SS Wheel Plastic hub, grey color polyurethane tire

Brake type	mm	mm	mm	mm	mm	mm	mm	mm	kg	Code
<b>TB/BS</b> Total locking brake	75	32		95 x 70	75 x 52 / 72 x 45	9.0	33.0	107.0	50	Y380XP1SS/W300S
	75	32		77 x 67	61.5 x 52 / 56 x 45	8.5	33.0	107.0	50	Y380XP2SS/W300S
	100	32		95 x 70	75 x 52 / 72 x 45	9.0	40.5	135.0	80	Y480XP1SS/W400DS
	100	32		77 x 67	61.5 x 52 / 56 x 45	8.5	40.5	135.0	80	Y480XP2SS/W400DS
	125	32		95 x 70	75 x 52 / 72 x 45	9.0	39.0	161.0	100	Y580XP1SS/W500DS
	125	32		77 x 67	61.5 x 52 / 56 x 45	8.5	39.0	161.0	100	Y580XP2SS/W500DS
	150	32		95 x 70	75 x 52 / 72 x 45	9.0	50.0	189.5	100	Y680XP1SS/W600DS
	150	32		77 x 67	61.5 x 52 / 56 x 45	8.5	50.0	189.5	100	Y680XP2SS/W600DS
<b>TB/BS</b> Total locking brake	75	32		95 x 70	75 x 52 / 72 x 45	9.0	41.0	107.0	50	Y380P1SS/W300S
	75	32		77 x 67	61.5 x 52 / 56 x 45	8.5	41.0	107.0	50	Y380P2SS/W300S
	100	32		95 x 70	75 x 52 / 72 x 45	9.0	40.5	135.0	80	Y480P1SS/W400DS
	100	32		77 x 67	61.5 x 52 / 56 x 45	8.5	40.5	135.0	80	Y480P2SS/W400DS
	125	32		95 x 70	75 x 52 / 72 x 45	9.0	39.0	161.0	100	Y580P1SS/W500DS
	125	32		77 x 67	61.5 x 52 / 56 x 45	8.5	39.0	161.0	100	Y580P2SS/W500DS
	150	32		95 x 70	75 x 52 / 72 x 45	9.0	46.5	189.5	100	Y680P1SS/W600DS
	150	32		77 x 67	61.5 x 52 / 56 x 45	8.5	46.5	189.5	100	Y680P2SS/W600DS



Stainless steel

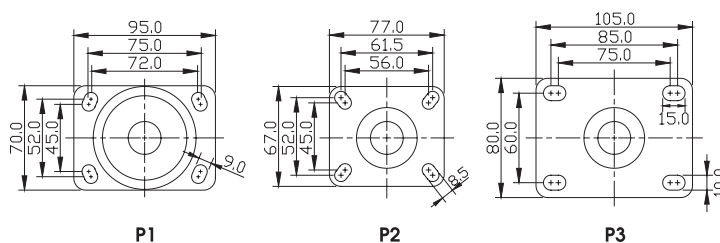

# DURARO

## Stainless Steel Castors

Pressed stainless steel double ballrace swivel yoke, electrolytic polishing finish



**TB/** Total locking brake  
Total Lock system locks both swivel head and wheel simultaneously for secure parking. Integrated ON/OFF Nylon brake pedals for easy and quiet operation.



**DB/** Directional locking brake  
Directional Lock permits free wheel rotation while swivel head remains locked, an easy way to keep equipment traveling straight. Integrated ON/OFF Nylon brake pedals for easy and quiet operation. Release pedal in green color.

### P Top Plate Fitting

#### TPU-SS Wheel Plastic hub, grey color polyurethane tire

Brake type	mm	mm	mm	mm	mm	mm	mm	mm	kg	Code
<b>DB/</b> Dir. locking brake	75	32		95 x 70	75 x 52 / 72 x 45	9.0	33.0	107.0	50	Y380XDP1SS/W300S
	75	32		77 x 67	61.5 x 52 / 56 x 45	8.5	33.0	107.0	50	Y380XDP2SS/W300S
	100	32		95 x 70	75 x 52 / 72 x 45	9.0	40.5	135.0	80	Y480XDP1SS/W400DS
	100	32		77 x 67	61.5 x 52 / 56 x 45	8.5	40.5	135.0	80	Y480XDP2SS/W400DS
	125	32		95 x 70	75 x 52 / 72 x 45	9.0	39.0	161.0	100	Y580XDP1SS/W500DS
	125	32		77 x 67	61.5 x 52 / 56 x 45	8.5	39.0	161.0	100	Y580XDP2SS/W500DS
	150	32		95 x 70	75 x 52 / 72 x 45	9.0	50.0	189.5	100	Y680XDP1SS/W600DS
	150	32		77 x 67	61.5 x 52 / 56 x 45	8.5	50.0	189.5	100	Y680XDP2SS/W600DS
Non-brake Free swivel	75	32		95 x 70	75 x 52 / 72 x 45	9.0	33.0	107.0	50	Y381P1SS/W300S
	75	32		77 x 67	61.5 x 52 / 56 x 45	8.5	33.0	107.0	50	Y381P2SS/W300S
	75	32		105 x 80	85 x 60 / 75 x 60	10.0	33.0	107.0	50	Y381P3SS/W300S
	100	32		95 x 70	75 x 52 / 72 x 45	9.0	40.5	135.0	80	Y481P1SS/W400DS
	100	32		77 x 67	61.5 x 52 / 56 x 45	8.5	40.5	135.0	80	Y481P2SS/W400DS
	100	32		105 x 80	85 x 60 / 75 x 60	10.0	40.5	135.0	80	Y481P3SS/W400DS
	125	32		95 x 70	75 x 52 / 72 x 45	9.0	39.0	161.0	100	Y581P1SS/W500DS
	125	32		77 x 67	61.5 x 52 / 56 x 45	8.5	39.0	161.0	100	Y581P2SS/W500DS
	125	32		105 x 80	85 x 60 / 75 x 60	10.0	39.0	161.0	100	Y581P3SS/W500DS
	150	32		95 x 70	75 x 52 / 72 x 45	9.0	50.0	189.5	100	Y681P1SS/W600DS
	150	32		77 x 67	61.5 x 52 / 56 x 45	8.5	50.0	189.5	100	Y681P2SS/W600DS
	150	32		105 x 80	85 x 60 / 75 x 60	10.0	50.0	189.5	100	Y681P3SS/W600DS

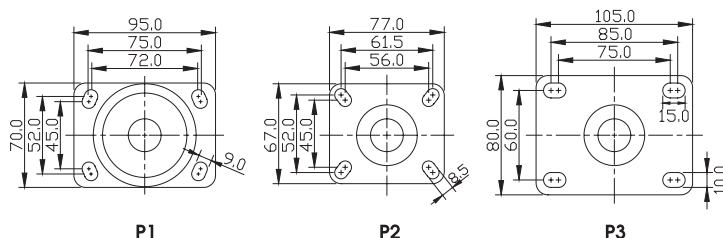





**TB** Total locking brake  
 Total Lock system simultaneously locks both swivel head and wheel for a secure parking.  
 Zinc-alloy brake pedal.

## P Top Plate Fitting

### TPU-SS Wheel Plastic hub, grey color polyurethane tire

Brake type	mm	mm	mm	mm	mm	mm	mm	kg	Code	
Non-brake	75	32		95 x 77	75 x 52 / 72 x 45	9.0	107.0	50	Y382P1SS/W300S	
Fixed	100	32		95 x 77	75 x 52 / 72 x 45	9.0	135.0	80	Y482P1SS/W400DS	
	125	32		95 x 77	75 x 52 / 72 x 45	9.0	161.0	100	Y582P1SS/W500DS	
	150	32		95 x 77	75 x 52 / 72 x 45	9.0	189.5	100	Y682P1SS/W600DS	
	75	32		67 x 77	52 x 61.5 / 45 x 56	8.5	107.0	50	Y385P2SS/W300S	
	100	32		67 x 77	52 x 61.5 / 45 x 56	8.5	135.0	80	Y485P2SS/W400DS	
	125	32		67 x 77	52 x 61.5 / 45 x 56	8.5	161.0	100	Y585P2SS/W500DS	

Stainless steel

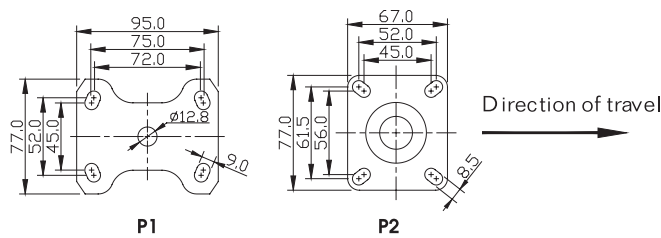

# DURARO

## Stainless Steel Castors

Pressed stainless steel double ballrace swivel yoke, electrolytic polishing finish



**TB/A** Total locking brake  
Total Lock system locks both swivel head and wheel simultaneously for secure parking. Integrated ON/OFF Nylon brake pedals for easy and quiet operation.



**DB/A** Directional locking brake  
Directional Lock permits free wheel rotation while swivel head remains locked, an easy way to keep equipment traveling straight. Integrated ON/OFF Nylon brake pedals for easy and quiet operation. Release pedal in green color.

### P Top Plate Fitting



#### PM-SS Wheel

Solid nylon wheel, stainless steel roller bearing, stainless steel threadguards

Brake type	mm	mm		mm	mm	mm	mm	mm	mm	kg	Code
<b>TB/A</b> Total locking brake	75	32		95 x 70	75 x 52 / 72 x 45	9.0	33.0	107.0	50		Y380XP1SS/W309RXS
	75	32		77 x 67	61.5 x 52 / 56 x 45	8.5	33.0	107.0	50		Y380XP2SS/W309RXS
	100	32		95 x 70	75 x 52 / 72 x 45	9.0	40.5	135.0	80		Y480XP1SS/W409RXS
	100	32		77 x 67	61.5 x 52 / 56 x 45	8.5	40.5	135.0	80		Y480XP2SS/W409RXS
	125	32		95 x 70	75 x 52 / 72 x 45	9.0	39.0	161.0	100		Y580XP1SS/W509RXS
	125	32		77 x 67	61.5 x 52 / 56 x 45	8.5	39.0	161.0	100		Y580XP2SS/W509RXS
<b>TB/B</b> Total locking brake	75	32		95 x 70	75 x 52 / 72 x 45	9.0	41.0	107.0	50		Y380P1SS/W309RXS
	75	32		77 x 67	61.5 x 52 / 56 x 45	8.5	41.0	107.0	50		Y380P2SS/W309RXS
	100	32		95 x 70	75 x 52 / 72 x 45	9.0	40.5	135.0	80		Y480P1SS/W409RXS
	100	32		77 x 67	61.5 x 52 / 56 x 45	8.5	40.5	135.0	80		Y480P2SS/W409RXS
	125	32		95 x 70	75 x 52 / 72 x 45	9.0	39.0	161.0	100		Y580P1SS/W509RXS
	125	32		77 x 67	61.5 x 52 / 56 x 45	8.5	39.0	161.0	100		Y580P2SS/W509RXS
<b>DB/A</b> Dir. locking brake	75	32		95 x 70	75 x 52 / 72 x 45	9.0	33.0	107.0	50		Y380XDP1SS/W309RXS
	75	32		77 x 67	61.5 x 52 / 56 x 45	8.5	33.0	107.0	50		Y380XDP2SS/W309RXS
	100	32		95 x 70	75 x 52 / 72 x 45	9.0	40.5	135.0	80		Y480XDP1SS/W409RXS
	100	32		77 x 67	61.5 x 52 / 56 x 45	8.5	40.5	135.0	80		Y480XDP2SS/W409RXS
	125	32		95 x 70	75 x 52 / 72 x 45	9.0	39.0	161.0	100		Y580XDP1SS/W509RXS
	125	32		77 x 67	61.5 x 52 / 56 x 45	8.5	39.0	161.0	100		Y580XDP2SS/W509RXS

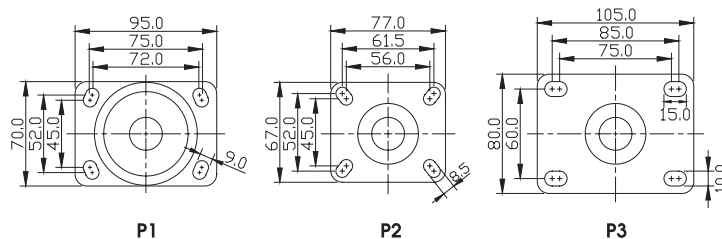



**TB** Total locking brake  
 Total Lock system simultaneously locks both swivel head and wheel for a secure parking.  
 Zinc-alloy brake pedal.

## P Top Plate Fitting



### PM-SS Wheel Solid nylon wheel, stainless steel roller bearing, stainless steel threadguards

Brake type	mm	mm	mm	mm	mm	mm	mm	mm	kg	Code
Non-brake Free swivel	75	32		95 x 70	75 x 52 / 72 x 45	9.0	33.0	107.0	50	Y381P1SS/W309RXS
	75	32		77 x 67	61.5 x 52 / 56 x 45	8.5	33.0	107.0	50	Y381P2SS/W309RXS
	75	32		105 x 80	85 x 60 / 75 x 60	10.0	33.0	107.0	50	Y381P3SS/W309RXS
	100	32		95 x 70	75 x 52 / 72 x 45	9.0	40.5	135.0	80	Y481P1SS/W409RXS
	100	32		77 x 67	61.5 x 52 / 56 x 45	8.5	40.5	135.0	80	Y481P2SS/W409RXS
	100	32		105 x 80	85 x 60 / 75 x 60	10.0	40.5	135.0	80	Y481P3SS/W409RXS
	125	32		95 x 70	75 x 52 / 72 x 45	9.0	39.0	161.0	100	Y581P1SS/W509RXS
	125	32		77 x 67	61.5 x 52 / 56 x 45	8.5	39.0	161.0	100	Y581P2SS/W509RXS
	125	32		105 x 80	85 x 60 / 75 x 60	10.0	39.0	161.0	100	Y581P3SS/W509RXS



Brake type	mm	mm	mm	mm	mm	mm	mm	kg	Code
Non-brake Fixed	75	32		95 x 77	75 x 52 / 72 x 45	9.0	107.0	50	Y382P1SS/W309RXS
	100	32		95 x 77	75 x 52 / 72 x 45	9.0	135.0	80	Y482P1SS/W409RXS
	125	32		95 x 77	75 x 52 / 72 x 45	9.0	161.0	100	Y582P1SS/W509RXS
Non-brake Fixed	75	32		67 x 77	52 x 61.5 / 45 x 56	8.5	107.0	50	Y385P2SS/W309RXS
	100	32		67 x 77	52 x 61.5 / 45 x 56	8.5	135.0	80	Y485P2SS/W409RXS
	125	32		67 x 77	52 x 61.5 / 45 x 56	8.5	161.0	100	Y585P2SS/W509RXS



Stainless steel

